

Neakasa Pet Grooming Kit **P2 PRO**

USER GUIDE

- FR GUIDE DE L'UTILISATEUR
- DE BENUTZERHANDBUCH
- JP ユーザーガイド
- 🇸🇬 用戶指南

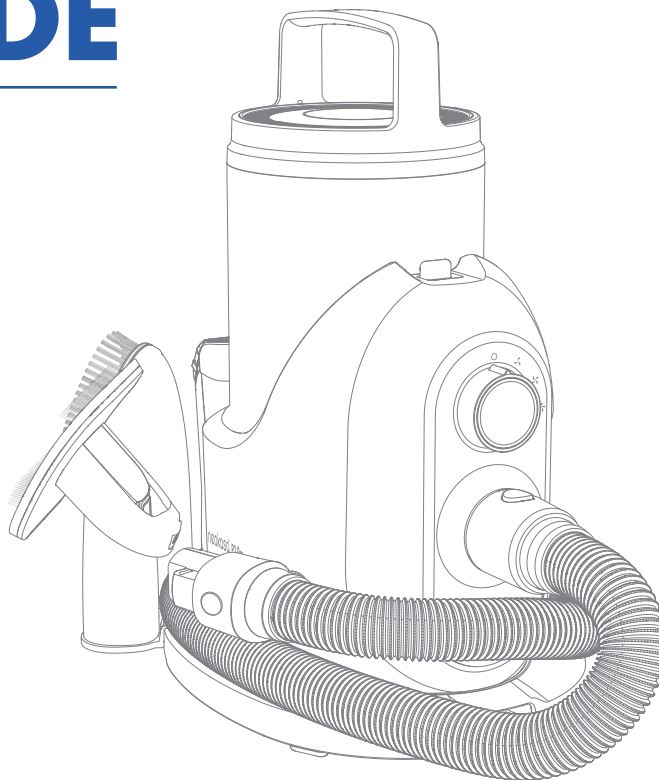

User Guide

• Safety Information	1-2
• Package Includes	3
• Get Started	4-6
• Customer Support	7
• Care and Maintenance	8-11
• Specifications	12
• Warranty	13

Guide de l'utilisateur

• Informations sur la sécurité	14-15
• La boîte comprend	16
• Démarrage	17-19
• Assistance à la clientèle	20
• Entretien et maintenance	21-24
• Spécifications	25
• Garantie	26

Benutzerhandbuch

• Sicherheitshinweise	27-28
• Lieferumfang	29
• Anwendung	30-32
• Kundendienst	33
• Pflege und Wartung	34-37
• Spezifikationen	38
• Garantie	39

ユーザーガイド

• 安全情報	40-41
• パッケージに含まれるもの	42
• 使用説明	43-45
• カスタマーサポート	46
• お手入れとメンテナンス	47-50
• 製品仕様	51
• 保証	52

用戶指南

• 安全須知	53-54
• 包裝包括	55
• 使用說明	56-58
• 售後服務	59
• 日常維護	60-63
• 產品規格	64
• 保固	65

General Warning

- This product is only for household use, not for commercial or industrial use, nor for outdoor or humid places;
- Never let children or people with weak thinking ability use this product alone;
- Use it in a safe environment and under the instructions and supervision of a person who understands the safe use of the product and its hazards. Under such circumstances, never let children use it;
- Pay full attention when using it near children and pets. In addition, be careful not to let children and pets play with this product;
- Do not touch the power plug and this product with wet hands, do not absorb moisture and liquid;
- Do not use this product when the power cord or power plug is damaged;
- In the case of malfunction, damage, or immersed in liquid, be sure to contact customer support;
- Do not disassemble the product, wrong assembly method may cause electric shock or fire, contact customer support when you need repair;
- Do not suck flammable or combustible liquids such as gasoline. Do not use it in an environment with flammable or combustible gas;
- Do not pull the power cord, or put heavy objects on the top of the machine. Do not clamp the wires to a closed door;
- Do not suck anything that is on fire, smoking, or high temperature such as cigarettes, matches, hot soot;
- Do not block the opening for use;
- Unplug the machine before maintenance;
- Do not use or keep it in humid places such as outdoors or bathroom;
- Do not use products with fragrances as filters. Such chemicals may become one of the causes of fire.
- Use it only with specified voltage. You can find the specified voltage on the bottom of your machine.

Cautions

- **Do not operate or unplug the power cord with wet hands.**
To avoid malfunction and electric shock, it is absolutely prohibited.
- **Do not suck smoke or other highly flammable things.**
Do not use it in places with flammable liquids or combustibles. It may cause fire or explosion.
- **There may be a peculiar smell when used for the first time. It will not cause adverse effects on the body.**
When using this product for the first time, there may be an odor but it will disappear after a while. understand. However, if the burnt smell persists, stop using it immediately!
- **Keep the dust cup and filter clean.**
If the dust cup and filter are used dirty, they may be the cause of a malfunction.
- **When maintaining, be sure to unplug the power cord before proceeding.**
If the power is turned on for maintenance, there will be a risk of electric shock or injuries.
- **The machine shuts itself down when the temperature rises abnormally.**
If abnormal heating of the motor occurs, the operation will be stopped immediately. If the suction port is blocked, the operation will be stopped immediately. To restart it, take out the dust cup, confirm that the suction port and filter are clean, and then turn it on after 60 minutes.
- **Be sure to use each filter with the installed state.**
If the machine is turned on with the filter removed, the motor may be damaged.

Package Includes

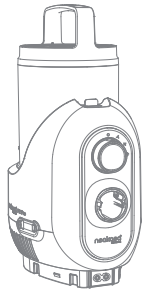

Vacuum Device*1



Vacuum Base*1



Accessory Holder*1



Hose*1

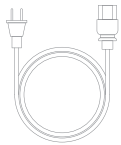

Wire*1



(extra)
Sponge Filter*1

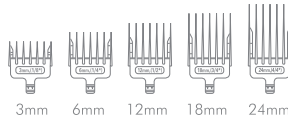

Clipping Comb*5



Wind Cover*1



User Guide*1



Grooming Brush*1



Deshedding Tool*1



Electric Clippers*1



Cleaning Brush*1



Nozzle*1

Note: If you find something missing in your package, please contact customer support via support@neakasa.com in time.

Get Started

EN

Get Ready

Put the dust cup gently in the direction of the arrow.

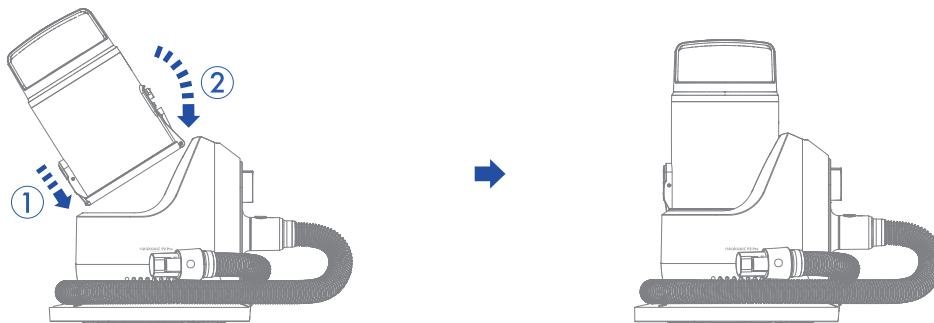

Connect the Accessory to the Vacuum Cleaner Through the Hose

When using accessories, please pay attention to the edges of the accessories to avoid scratching your hands.

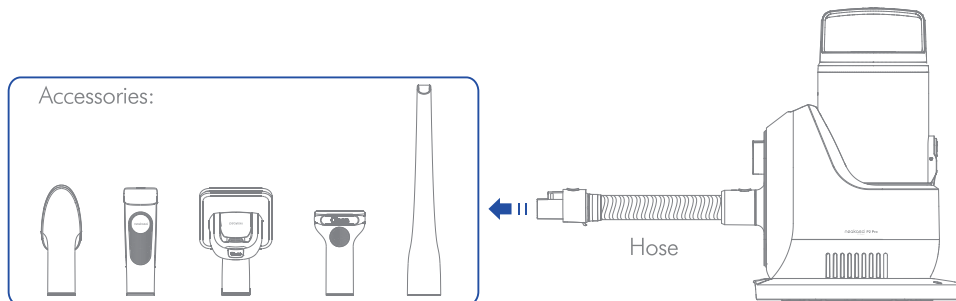

Adjustment of Electric Clippers

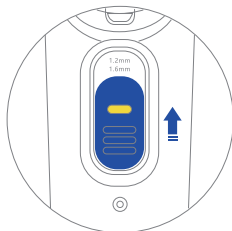
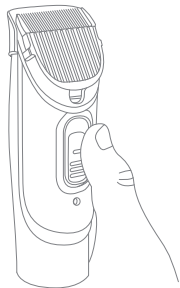



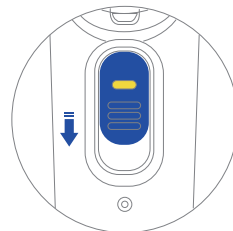

Reduce hair retention length
Slide up (don't press the yellow self-locking button in the above figure)

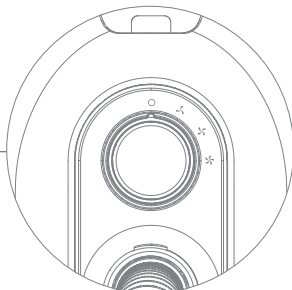
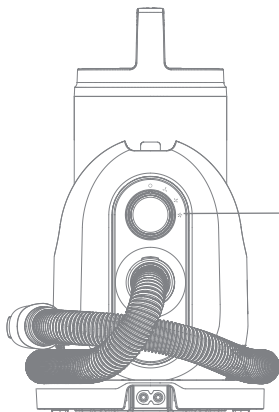

Increase hair retention length
Slide down (press and hold the yellow self-locking button in the above figure)

Use the Device



-  OFF
-  Eco mode
-  Standard mode
-  Boost mode

Use of Accessories

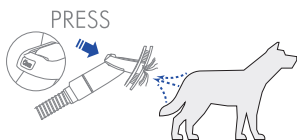

Grooming Brush

It can clean the floating hair on pets and the garbage in the hair, and at the same time it has the function of lengthening the hair, making the hair more fluffy.



Cleaning Brush

It can clean the hair from pets or from people's clothes.

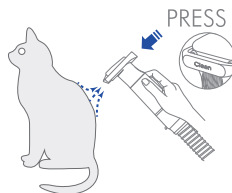

Deshedding Tool

Quickly and easily remove loose hair for long and short haired dogs and cats. Effectively reduce shedding by up to 95% of dead hair and tangles.
Note: During use, please pay attention to the cutting edge and sharp position, do not use excessive force to cause the skin scratches.

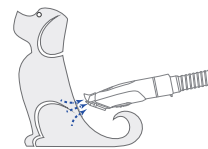

Electric Clippers

It can shave your pet's hair and suck it into the dust cup to prevent it from falling elsewhere.
Note: Please be careful on the soft parts of the pet's skin and do not use excessive force to cause skin scratches.

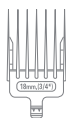

Clipping Comb

According to different hair style needs to choose. (optional use)
Note: The objects are scattered and small, please keep them properly placed when not in use.

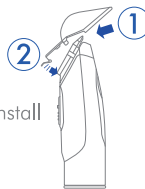

Install



Take apart



Wind Cover

It is used to enhance the suction force of the tuyere when trimming hair, and at the same time guide the path of the suction port. (optional use)
Note: The objects are scattered and small, please keep them properly placed when not in use.

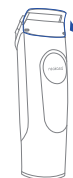
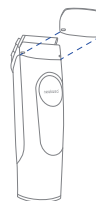

Customer Support

EN

If you have other questions or comments about your product, please contact us via support@neakasa.com or our Facebook [@neakasa.tech](https://www.facebook.com/neakasa.tech).

Clean the Dust Cup

1. Remove the dust cup: Lift slightly in the arrow direction to remove the dust cup.

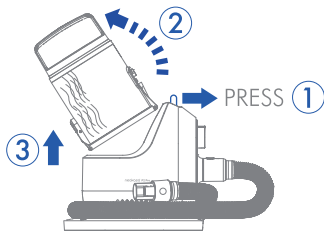

2. Press ①, push the blue buckle to dump out the trash.

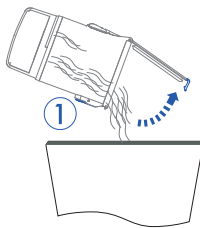

3. Install the dust cup: install the dust cup in the direction of the arrow.

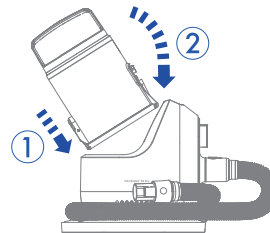

Note:

- Be careful when handling the dust cup.
- If the removed dust cup is cleaned after being dumped with dust, remember to install the dust cup after it is dry to prevent water ingress in the motor and cause electric shock or damage to the machine.

Clean the Electric Clippers

1. Please retract the movable knife adjustment knob to the bottom before taking the knife.



2. Vacuum/clean debris from the blade and the clipper.

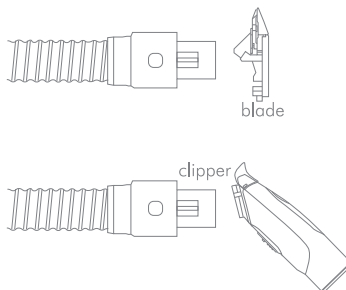

3. Drop some lubricant(not included) on the blade.

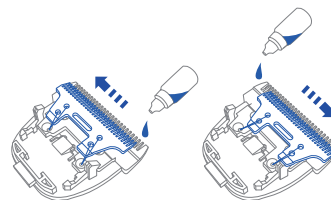

Clean HEPA

1. Remove the dust cup, take out the HEPA.

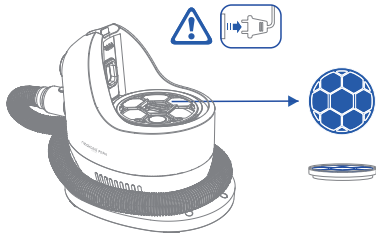

2. Wash with water, drain the water after washing.

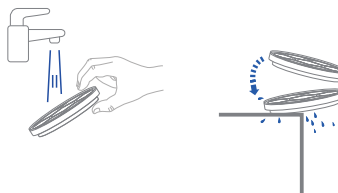

3. Place it in a well-ventilated place for at least 24 hours of drying.

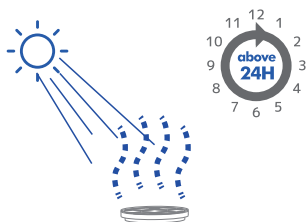

4. Install the HEPA back to the original place after it is completely dry, please be sure to install it properly.

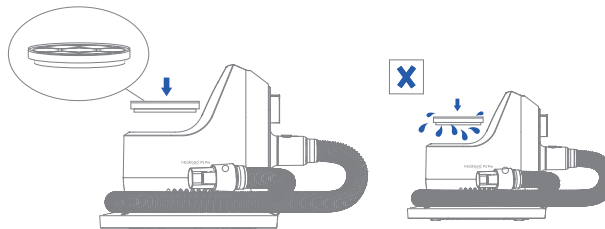

Note:

- The filter should be cleaned with cold water at least every other month.
- Please follow the frequency of use and conditions, the maintenance period is also different, regularly confirm if it is dirty, clean it.
- When cleaning, remember to disconnect the power supply and unplug the plug from the socket.
- Be sure to install HEPA after drying.
- No-yet-dry HEPA can cause electric shock and malfunction.

Cleaning the Sponge Filter

1. Remove the dust cup and take out the sponge.

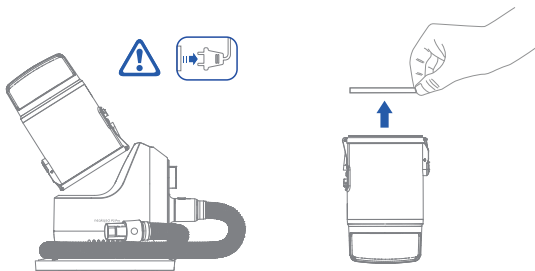

2. Please wash with tap water, and drain the water after washing.



3. Put it in a well-ventilated place for at least 24 hours of drying treatment.

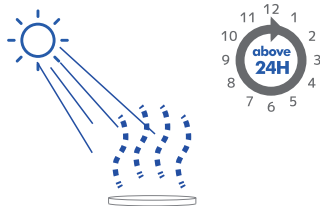

4. Install the sponge back to its original place after it is completely dry. Be sure to install the sponge correctly.

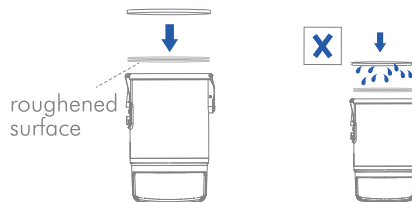

Note:

- The filter should be cleaned with cold water.
- The maintenance period follows the frequency of use, regularly confirm if it is dirty, clean it.
- When cleaning, unplug it from the socket.
- Be sure to install sponge filter after drying.
- Wet sponge filter can cause electric shock and malfunction.

Hose Storage Method

Wrap the hose clockwise around the device, and the hose snaps into the buckle on the side of the device to fix it.

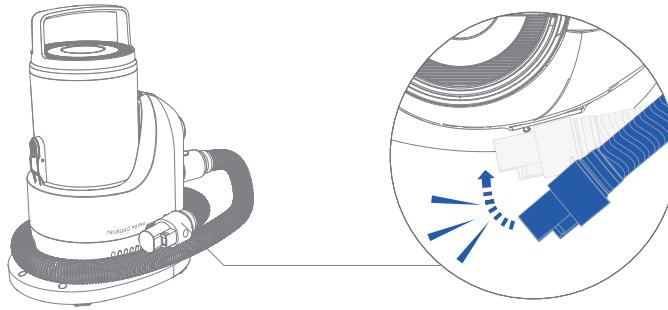

Specifications

Rated Power:	400 W
Hose Length:	1.5 m / 59 inch
Suction Power:	35 W
Dust Cup Capacity:	2 L / 67.6 oz
Product Size:	290*132*210 mm / 11.4*5.2*8.3 inch
Wire Length:	2.5 m / 98.4 inch
N.W.:	2.5 kg / 5.5 lbs
Maximum Noise:	74 dBA

1. The warranty period is 12 months from the date of purchase. The warranty is only limited to free repair of the product purchased. Consumables and accessories are not subject to warranty.
2. If it is damaged or malfunctioned during normal use, it will be repaired free of charge within the warranty period. If it cannot be repaired, a replacement will be provided.
3. The following conditions are paid repairs even during the warranty period:
 - (a) Failure and damage caused by misuse or carelessness;
 - (b) Damage due to shipping;
 - (c) Damage caused by pets (scratches, bites, touching the body or riding products);
 - (d) Failure and damage caused by fire, earthquake, and other natural disasters;
 - (e) Failure and damage during use other than general household use (long-term use for business, etc.);
4. In the following situations, no repairs will be provided regardless of the warranty period:
 - (a) Products not purchased directly from Neakasa sales channels (e.g personal sales, auctions, etc.);
 - (b) The customer disassembles the product or tries to reform it;
 - (c) Consumables and accessories.
5. Shipping cost will be borne or reimbursed by Neakasa when the product is covered by warranty service. However cost of packaging materials will not be covered.
6. If it is not covered by the warranty, shipping cost and repair fees will be charged when returning.
7. The warranty period for the exchanged product is subject to the warranty period before the exchange (counted from the original purchase date);
8. Repair or replacement is only valid in certain countries.
9. Please contact support@neakasa.com for guidance if you have a question or need to repair.
10. Regulations may be changed without notice. Neakasa reserves the rights to update warranty when needed. All repairs and request will be handled according to the most updated warranty.