

版本号	20220315
产品型号	21526
尺寸	30.4*15.3cm
材质/工艺	70g双胶纸双面印刷
印刷颜色	单色
其他要求	

# Aqualin®

## INSTRUCTION BIG SMILE CLICK & PULL WATER TIMER MODEL#YL21526

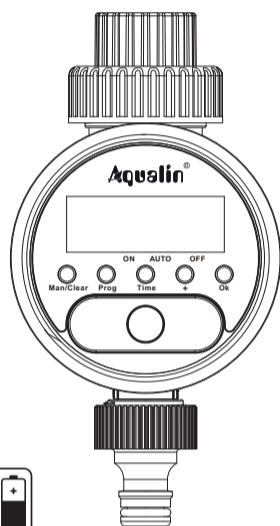

**2x**  
**AA**  
Alkaline  
Not Included

### TIMER FEATURES

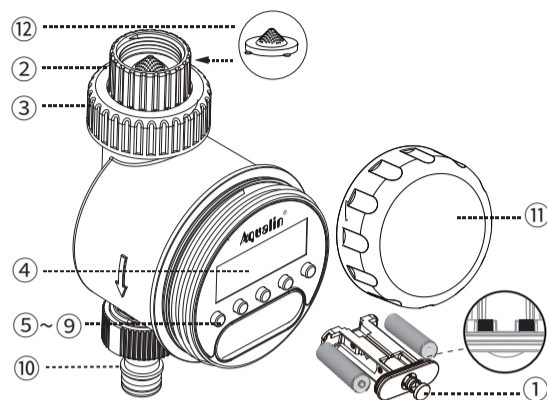

- ① Battery compartment
- ② 3/4" tap adaptor
- ③ Collar ring
- ④ LCD Display
- ⑤ Man/Clr button
- ⑥ Prog button
- ⑦ Time button
- ⑧ + button
- ⑨ OK button
- ⑩ Snap-on connector
- ⑪ Top cover
- ⑫ Filter

- ① CLICK & PULL battery compartment**  
Press the middle dot until the dot pin pop out, then hold the pin to pull out the battery box and insert 2x (LR6/AA)1.5V alkaline batteries. Make sure the + or - polarity is correct, and two metal battery contacts face to top side.

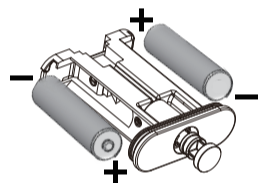

- ⚠ WARNING**  
a. Use only fresh alkaline batteries at the beginning of the season. **DO NOT** use rechargeable batteries.  
b. Press the Man/Clear button to Auto or OFF position before connecting to tap.

- ② 3/4" Tap adaptor & ③ Collar ring**  
Turn loose the collar ring until the tap adaptor is unlocked, screw the tap adaptor on to the tap tight and then lock them tight with the collar ring.

- ⚠ WARNING**  
DO NOT use spanners or pliers to avoid damage to the timer.

- ④ LCD display**  
1. press the Man/Clear button until the indicator rest at AUTO position, to run set watering cycles.



2. When timer is ON, you will see the watering icon.



3. When LCD display show a quick flashing low battery sign, remove the battery compartment and wait for 60 seconds until screen clears before re-insert the new batteries.

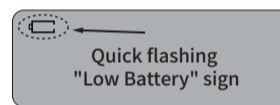

- ⑤ Man/Clear button**  
Press the man/clear button until the indicator rest at the ON position to open the valve manually, and close the valve by resting the indicator at OFF position. Place the indicator at the AUTO position to run the set watering schedules.

- ⑥ Prog button**  
Set at max 8 watering programs.

- ⑦ Time button**  
Enter clock time setting or exist setting during programming.

- ⑧ + button**  
Adjust settings in time and program.

- ⑨ OK button**  
Confirm setting.

- ⑩ Snap-on connector**  
Connect hose attachment to the snap-on connector at the bottom of the timer.

- ⑪ Top cover**  
Screw tight the top cover to protect timer from dust and sun exposure.

- ⑫ Filter**  
Filter traps dirt particles and prolong life of timer.

- ⚠ WARNING**  
Clean filter regularly and replace if worn.

### PROGRAM TIMER SET CLOCK

Press time button to enter clock time setting, adjust by + button and confirm by OK button

### SET WATERING SCHEDULES (MAX 8 CYCLES)



Make sure indicator rest at AUTO (set by Man/Clear button if not), there are 8 ON/OFF watering cycles available.

Press prog button to enter setting, adjust by + button until the desired watering days show on the screen and confirm by OK button. Day combinations can be:

1	MO	6	SA	11	MO TU WE
2	TU	7	SU	12	TH FR SA
3	WE	8	MO WE FR	13	MO TU WE TH FR
4	TH	9	TU TH SA	14	MO TU WE TH FR SA
5	FR	10	SA SU	15	MO TU WE TH FR SA SU

Set 1st watering ON time by + button and confirm by OK button, then set the same way for 1st watering OFF time.

EXAMPLE#1: To water every Monday for 15 minutes from 9:00 to 9:15.



EXAMPLE#2: To water every day for 30 minutes from 10:00 to 10:30.



Press the + button until every day of the week (MO TU WE TH FR SA SU) are selected



### ⚠ SPECIAL NOTES DURING SETTINGS:

- OFF time shall be within 6 hours 15 minutes after ON time for each cycle.
- During program setting, press time button to quit setting.
- During program setting, press Man/Clear button to remove setting to none.



### MANUAL WATERING

- To start manual watering, press the Man/Clear button to ON.

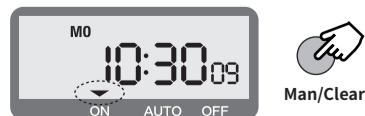

- To stop manual watering, press the Man/Clear button to OFF.

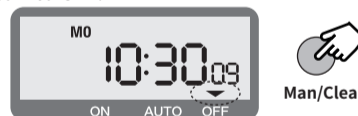

- To resume the set watering cycles, press the Man/Clear button back to AUTO.

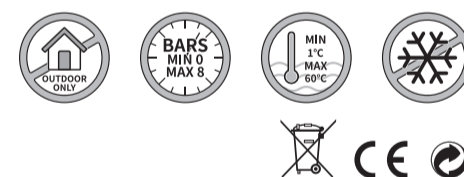
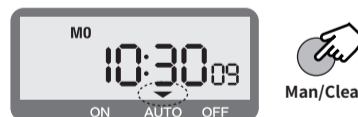

### PROTECT TIMER FROM DAMAGE

- This timer is only designed for outdoor use to control sprinklers or irrigation systems for watering, and can not be used for industrial purposes which in contact with food, chemicals and pesticides.
- Operating water pressure is from **0 bar to 8 bars** (0 psi to 116 psi).
- Use with clean and freshwater only whose temperature shall be above **1°C** and below **60°C**.
- Protect timer during winter season or freezing conditions. Remove from tap and drain water inside, remove batteries and keep indoors.
- Screw tight the top cover to protect timer from dust and sun exposure.
- Timer is water resistant, **NOT** water proof. The timer must be installed above ground and vertically to the tap. **DO NOT** submerge it in water.
- DO NOT** pull the hose while attached to the timer, to avoid damage to timer.
- If timer doesnot work, please read through instruction to double check or contact your store service before returning to the store.